



Illinois Capital Development Board  
Art-in-Architecture Program

# Request for Qualifications

for

*Illinois Central College  
Workforce Sustainability Center  
East Peoria, Illinois  
Project Number: 810-036-020*

## CALL TO ARTISTS

The Art-in-Architecture Program of the Capital Development Board is pleased to announce a Request for Qualifications (RFQ) to Illinois professional artists to create permanent original public art for the Workforce Sustainability Center on the Illinois Central College (ICC) campus in East Peoria, Illinois.

**Final Deadline:** Friday, April 30, 2021  
4:30 P.M.  
**E-MAIL SUBMITTALS ARE NOW REQUIRED.**

## ELIGIBILITY

These public art commissions and potential purchases are open to all professional artists, artisans, or artist-led teams *that live and work in the state of Illinois*.

- An artist/artisan is defined as a skilled practitioner that generates designs and concepts for creative works that reflect form, beauty, and aesthetic perception. All artists on a team must be from Illinois.
- Subcontractors may be used and are defined as those providing technical implementation such as construction, fabrication, and/or assembly for portions or all of a finished product under direct supervision and control of an artist.
- Faculty and staff of Illinois Central College are not eligible to apply for this commission.

## PROJECT SUMMARY

In the Peoria area, 60% of jobs require a credential past high school but only 40% of adults in the region have one. This project is part of a statewide drive to raise the percentage of credentialed workers to 60% by the year 2025.

The new ICC Workforce Sustainability Center will help both first-time students and career changers. As more area workers develop skills to support the needs of growing businesses, they will help communities attract new investment and support a prosperous economy.

The facility will house programs most essential to accelerating workforce development and manufacturing in the region including

- |                           |                                   |
|---------------------------|-----------------------------------|
| * Geothermal/HVAC         | * Solar installation              |
| * Truck driver training   | * Highway construction            |
| * Computer-aided drafting | * Machinist training              |
| * Pre-apprentice programs | * Manufacturing training programs |

## PROJECT SITE

The new Workforce Sustainability Center building will look across the pond and to the rest of the ICC campus. The building will be settled into the landscape to preserve existing trees and optimize opportunities for views.

A long, two-story lounge area features a two-story glass wall that runs along one side giving students a place to study and spend time. The area will also serve as a pre-event space for campus and industry events. An overhead view of the lounge and glass wall is provided by a second-floor bridge corridor. The entire area overlooks the geothermal well that will feed the HVAC training equipment.

The exterior artwork will be nested into the 'L' created by the lounge on one side and classrooms on the other. It will greet visitors as they approach the building and be visible to the campus community and visitors in the lounge space.

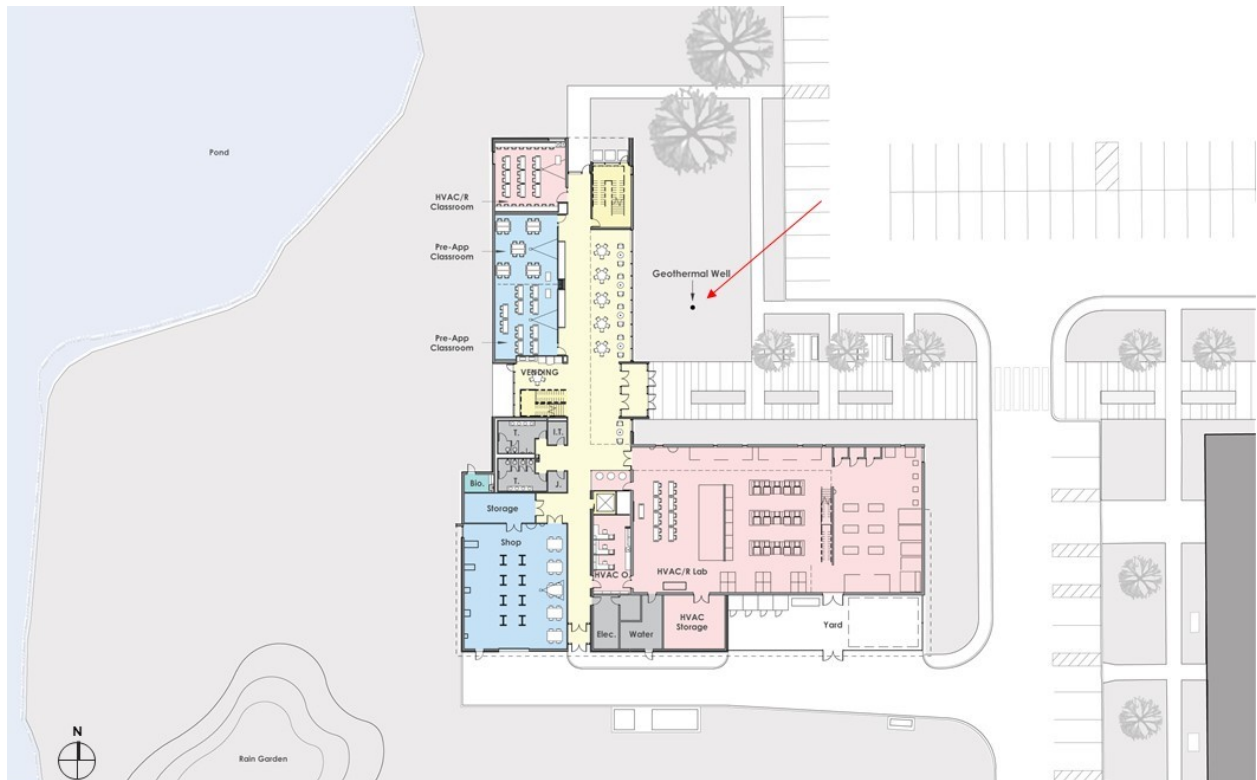

## ARTISTIC OBJECTIVES

The Committee is seeking a simple lighted exterior piece, pieces, or installation to enliven the exterior of the building, prompt the concept of harnessed energy as the artwork will be near the geothermal well, and provide a welcoming beacon to the campus community and visitors.

Other than the incorporation of light in the project, the committee has no preferred theme, media or format. While the artwork will be in a semi-industrial setting it does not want to be limited by manufacturing, trades, or the industrial arts in theme or execution.

The piece(s) must be durable, safe, and be able to withstand long-term exposure to the extremes of the Illinois climate.

## BUDGET DETAILS

The budget for the project is \$31,000.00. Illinois Central College will also provide in-kind funding in the form of assistance with installation of the artwork at the project site. Specifics of this in-kind assistance will be negotiated with the artist and College after the final selection has been made

This budget covers all expenses associated with, but not limited to the project design, labor, fabrication, project management, materials, tools, contracted services, operations and meetings, and travel required to complete the artwork plus installation, related permits, licenses, taxes and insurance, and transportation and delivery of the work to the site, as well as documentation of the completed project. Any expense that exceeds the contracted amount will be the artist's responsibility.

The artist is responsible for working with the Capital Development Board Art-in-Architecture Program, the using agency, and other relevant partners to oversee all aspects of the art installation.

## SELECTION PROCESS

At least three artists/teams will be selected from the pool of eligible artists/teams and paid a fee of \$1,000.00 each to develop and present site specific proposals.

Letters will be sent to the selected artists/teams with details of the proposal process and contracts.

*Do not send a proposal unless you have been contacted by the Art-in-Architecture Coordinator.*

## LEGAL AGREEMENT

The Capital Development Board Art-in-Architecture Program reserves the right to alter any aspect of the selection process or overall project in any way for its own convenience at any time. This Request for Qualifications does not constitute either an expressed or implied contract and these provisions are subject to change.

---

## HOW TO APPLY

### IF YOU HAVE ALREADY APPLIED TO THE ILLINOIS ART-IN-ARCHITECTURE PROGRAM

You do not need to send your materials again if you have previously applied and your portfolio is on file. To apply for this project submit a Letter of Intent that includes

- the project name and project number
- your name and the name of your team members if applying as a team
- your most current contact information including address, telephone number, and e-mail address

### IF YOU HAVE NEVER APPLIED TO THE ILLINOIS ART-IN-ARCHITECTURE PROGRAM OR WISH TO UPDATE YOUR PORTFOLIO

Please e-mail a full package including each of the following *labeled with the artist's name as well as the project name and number*:

- *Résumé* (if a team, one for each member) with current contact information, including:
  - Name
  - Address
  - Phone
  - Fax
  - E-mail
  - Website
- *Artist Statement/Letter of Intent* (1 page maximum, double spaced)
  - If the submission is on behalf of a team, please identify the lead artist and indicate if the individuals have previously collaborated and the nature of the collaboration.
  - If the artist or artist team has worked with not-for-profit organizations, local governments, state agencies, or other similar and relevant groups, please describe the project.
- *Up to 15 JPEG images of relevant past work*. Please provide the images in the following format:
  - One image per JPEG
  - Pixel dimensions per image: approximately 600 x 800
  - Image resolution: 72-300 pixels per inch
  - Maximum file size per image: 1MB
  - Name each image: lastnamefirstnameimagenumber.jpg, for example: mirojoan01, mirojoan02, mirojoan03, etc.
  - A corresponding, numbered, annotated image list with title, media, dimensions, location, brief description, date of the work, project budget, and project partners, if applicable.

- When submitting by e-mail, please send images as attachments and not in the body of the e-mail.
- *References* of at least three professionals (commissioning agency or organization, design or arts professional, architect, landscape architect, engineer, etc.) who have a detailed knowledge of the artist's work and working methods. Include contact name, complete address, telephone number, and e-mail for each reference.
- *Optional* One PDF file of additional support material, including press clippings or other relevant information on past projects (maximum 1MB file.)
- *Digital Submittals*
  - *Email submittals are required.*
  - Ensure the images are sent as attachments and are not embedded within the email.
  - Large files may be sent using file sharing services. such as the state [of Illinois FTP site](#), Dropbox, and Microsoft OneDrive
- ***PowerPoint presentations are not accepted.***

Please Note:

- Send art images as JPEG files ONLY. Slides will not be accepted nor returned.
- **Do not send design proposals.**
- All submittals become property of the Capital Development Board Art-in-Architecture Program and will not be returned. Submissions can be made available for public viewing. The artist retains copyright.

## HOW AND WHERE TO SUBMIT

Interested artists must send application materials no later than **Friday, April 30, 2021 at 4:30 P.M.** Submissions received after this date will be kept for review for other Art-in-Architecture projects.

Application materials may be delivered by:

E-mail to **CDB.ArtinArchitecture@illinois.gov**

## QUESTIONS?

Contact the Art-in-Architecture Program at **CDB.ArtinArchitecture@illinois.gov**

The Art-in-Architecture Procedure Manual, commission opportunities, and other information is posted at [www.illinois.gov/cdb/professionalgrowth/art](http://www.illinois.gov/cdb/professionalgrowth/art).



---

## ABOUT THE ART-IN-ARCHITECTURE PROGRAM

The Illinois Art-in-Architecture Program promotes and preserves Illinois art and enriches communities by commissioning original artwork for public buildings constructed with State funds.

The enabling legislation for the Program requires that the Capital Development Board “shall set aside 1/2 of 1 percent of the amount authorized and appropriated for construction or reconstruction of each public building financed in whole or in part by State funds and generally accessible to and used by the public for purchase and placement of suitable works of art in such public buildings.” A committee including art professionals and the project architect, and oversees each project and selects the artwork.

Since its inception in 1977, the Art-in-Architecture Program has purchased or commissioned works of art by Illinois artists for public display throughout Illinois. For more information visit the [AIA Program website](#).

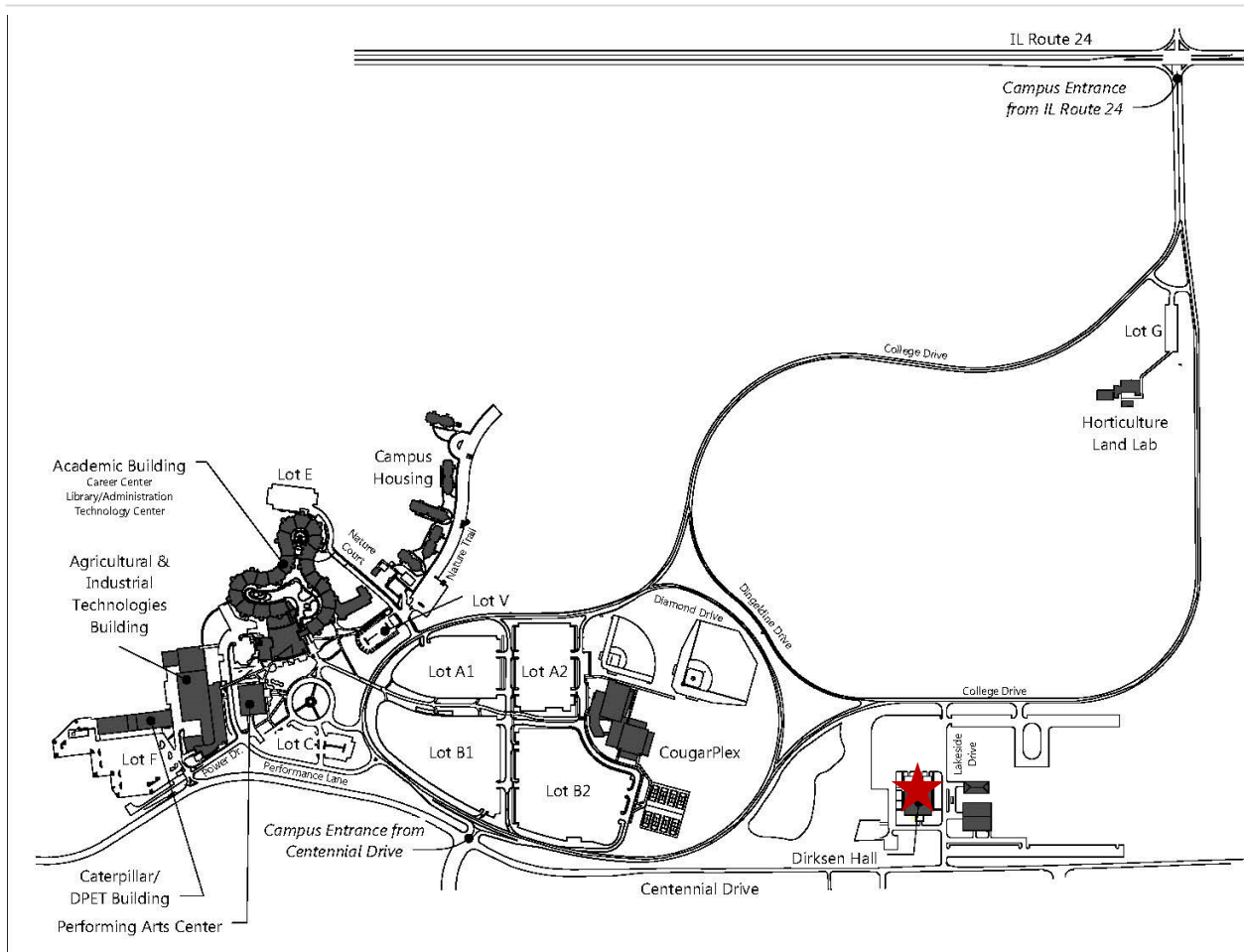

Campus map with project site.





Exterior showing artwork location



Illinois Central College  
 East Peoria, Illinois  
 810-036-020

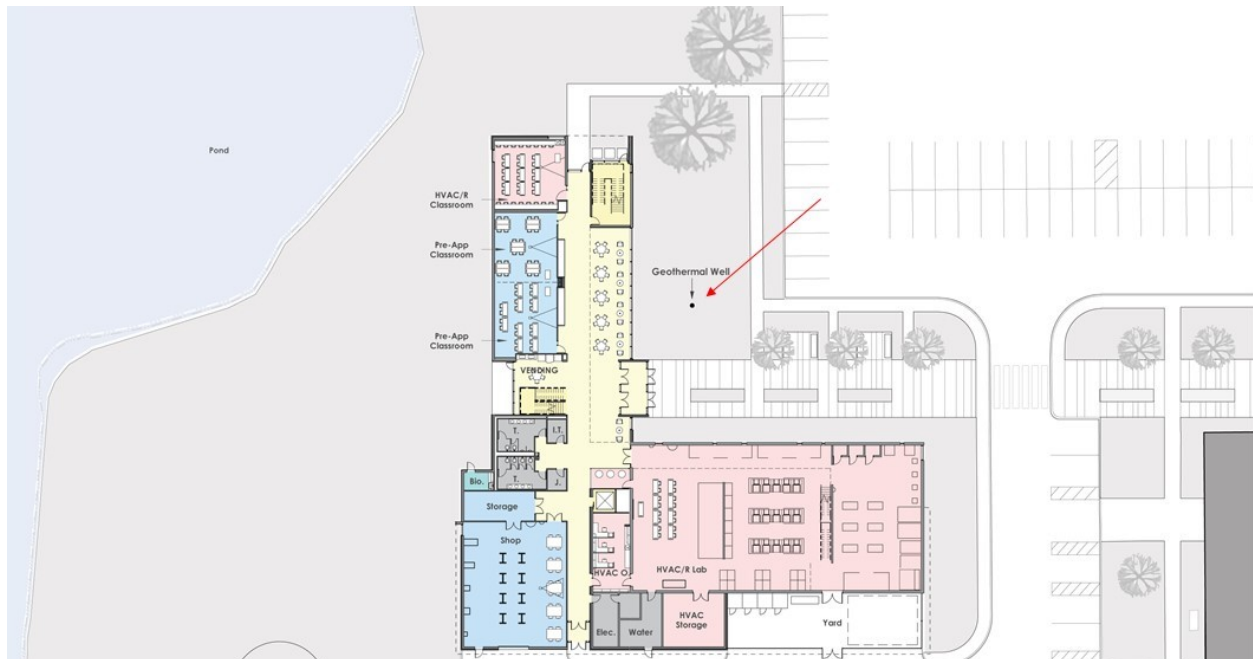

Building and site plans with artwork location

