

Public Art Program Request for Qualifications

Project Name: Lamar Institute of Technology Workforce and Allied Health Building

Texas State University System seeks to commission an artist or artist team to design artwork for the Lamar Institute of Technology Workforce and Allied Health Building.

Any project related questions will be answered at the Artist Information Session held:

May 10, 2023, 12:00 to 1:00 PM CST

Join Zoom Meeting: <https://txstate.zoom.us/j/99439397407?pwd=SGs4ZUpJckV1Vlc3RGNsSEhHb2F1UT09>

Meeting ID: 994 3939 7407

Passcode: 925269

Project History or Scope

Lamar Institute of Technology (“LIT”) traces its roots back to September 17, 1923, when South Park Junior College opened with 125 students and a faculty of 14. The LIT campus in Beaumont is about ninety miles east of Houston and about twenty-five miles west of Louisiana. In 1932, separate facilities were provided, and the name of the institution was changed to Lamar College, to honor Mirabeau B. Lamar, second president of the Republic of Texas and the “Father of Education” in Texas. On September 1, 1995, the Institute of Technology was established as an educational center of Lamar University and a Member of The Texas State University System. The Texas Legislature changed the name of the institution to Lamar Institute of Technology in 1999. Lamar Institute of Technology is a special purpose postsecondary coeducational organization, a two-year technical “Institute” that primarily offers associate degrees, certificates, and non-credit workforce skills training. LIT focuses on teaching excellence, student success and community engagement. It is an open-door postsecondary institution ready to serve all students. LIT provides a curriculum consisting of over 65 degree and certificate programs covering a wide range of career and technical educational opportunities. The mission of the Institute is to provide innovative teaching and learning for tomorrow’s workforce.

The new Workforce and Allied Health Training Center is envisioned as a two-story building with an embedded high-bay instructional space. The first floor will be a welcoming space with the main building lobby and student lounge. It will also include the majority of the workforce instructional space and simulation suite. The second floor will be dedicated to allied health and contain the skills labs, pharmacy technician labs, and main testing room. The new center will provide key capabilities for expanding workforce offerings, and the allied health nursing program. The building is intended to be oriented east-west on the site with its main public academic entry access from the western side, near the quad, and the industry partner entry to the eastern side. The site organization biases placing the more technical spaces, such as the industry flex closer to the southeast corner, and the general instructional spaces near the building entrance. The building lobby is envisioned as a two-story volume space. A unique feature discussed in programming is the ability to look down into the industry flex lab from the second floor.

Architect: PBK Architects/CMAR: Spaw Glass

Artwork Budget \$250,000

Artwork budget is all-inclusive of artist fees, other consultants’ and subcontractors’ fees, insurance, engineering, materials, fabrication, transportation, installation (including any site modification), lighting, and post-installation documentation.

Site Plan

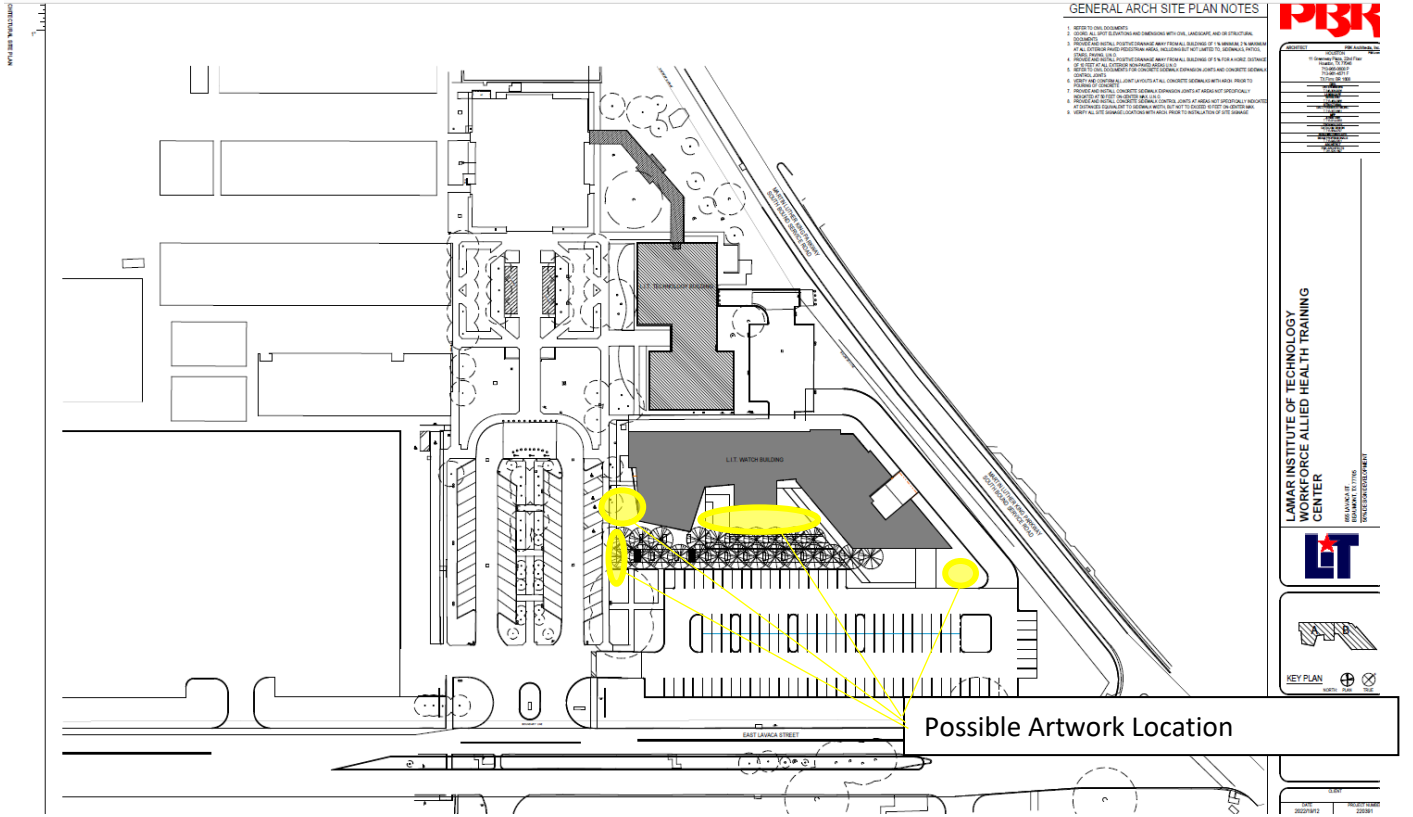

Potential Artwork Sites





Potential Public Art Project Goal(s)

Artwork will become an LIT icon and will be inspired by or related to the education students receive in support of the nation's most vital industries, including technology, industry, and healthcare.

Selection Process/Solicitation type

Open Call Request for Qualifications. Due to the construction timeline and budget of the project, this commission opportunity will be open to public artists living and working in the Southwestern states' region (Alabama, Arkansas, Colorado, Florida, Georgia, Louisiana, Mississippi, Montana, New Mexico, North Dakota, Oklahoma, South Dakota, Texas, Utah, and Wyoming). The Committee on Public Art (CoPA) will narrow the list of artists who applied, and the Director of Public Art will request paid proposals from the shortlist. The shortlisted artists will submit their proposals and be present for interviews with the CoPA. The CoPA will choose one selected artist and one alternate for review by the President and Chancellor.

Submission Requirements

Eligibility

- Age 18 or older
- Professional artist: A practitioner of visual and/or interdisciplinary arts, at any stage in their career, whose work is recognized by peer artists to demonstrate serious intent and ability, who has a body of work and has made art creation a focus of their practice.
- Lives or works in the Southwest Region (Alabama, Arkansas, Colorado, Florida, Georgia, Louisiana, Mississippi, Montana, New Mexico, North Dakota, Oklahoma, South Dakota, Texas, Utah, and Wyoming)

Preferred Qualifications

- Exhibited in a museum.
- Held in a museum collection.

Applications

Applications will be accepted via www.publicartist.org only.

- Artist Resume or CV (2 pages)
- Digital Images of past work (5-10)
- Artist Statement and Interest (700 maximum)
- References (3 names/emails)

Short listed artists will be notified via email and phone.

Paid Proposals will include:

- Written concept of artwork.
- Conceptual design with site specific preliminary rendering and approximate dimensions.
- Model and/or material sample of proposed work (TSUS will keep all models until a final award is made. Selected artist's model becomes part of the TSUS Public Art Collection. If you are not selected, please include return shipping materials and payment.)
- Draft breakdown of budget including any artist fee, travel, anticipated engineering, materials, fabrication, shipping, installation, foundation, insurance, post install professional photography, lighting, etc. TSUS is tax exempt.
- Tentative timeline.
- Anticipated maintenance requirements.
- Examples of completed artworks of a budget to what is being proposed.

Interviews will include 15 minutes for the artist presentation and 20 minutes for six questions transmitted to the short-listed artists prior to their interviews.

Evaluation Criteria

- Quality and aesthetics of artwork submitted.
- Sensitivity to the social, environmental, historical, educational and site contexts of each campus
- Ability to enrich and diversify the System's art collection.
- Demonstrate success based on experience, materials, feasibility, and maintenance.
- Effective communication and completeness of application
- Alignment with project specific public art goal(s) as outlined by the CoPA.

Timeline

Post RFQ	April 2023
Artist Information Meeting	May 2023
Artist Submissions due by	June 2023
Shortlist of Artists notified by	June 2023
Shortlist Interviews	Aug 2023
Commission awarded by	Aug 2023
Artwork Completion	July 2024
Construction Completion	July 2024